

※W型電軌工程實績用於中船、中鋼、台電、台機、台塑...等廠內設備。



▲ W850A.



▲ W320A.



▲ W320A.



▲ W320A.



▲ W850A. 雙層吊車要考慮上下層運作時防撞方案



▲ W320A.

坤溢企業股份有限公司

http://www.kyec-mit.com.tw
E-mail: taiwan.kyec@msa.hinet.net
總公司: 33378 桃園市龜山區頂湖二街65巷6號
TEL: (03) 3287888 FAX: (03) 3280770
台北服務處 / TEL: (02) 25948345 FAX: (02) 25968846
台中服務處 / TEL: (04) 23580075 FAX: (04) 23582646
高雄服務處 / TEL: (07) 732-3380 FAX: (07) 732-3360



本公司另備有各機種零組件及相關解決方案，歡迎來電洽詢！ -工程技術部-
(Welcom,contact with us about all parts or technical information,Thanks!)

2019/05 800

Globe Star
W型安全輸電軌道

320A. 600A. 850A.

W Type Power Rails



安全電軌·輸電系統

簡介：

W型安全軌道，是公司一項技術的突破。

本公司自民國六十三年創立以來，即秉持著技術、服務、可靠的理念，專業從事吊車修理及相關工程改善，並因屢次的零件取得不易，受制於國外的價格，且進口費時，故致力於零組件之生產及改良，而有幸榮獲多項專利，並將之標準化、本土化，目標是一律以現貨供應，縮短工程備料時間，回饋業界。

據知，德國自1912年即開始使用安全電軌，更鑑於裸銅線的安全性差，著手開始研發，進而量產60A~200A連續性軌道，深獲業界的支持與愛護。

累積經驗下，又見於市場無較高安培數電軌，而W型就是本公司的高安培數（參考德製電軌），所以品質是 **Globe Star** 最基本的要求。

業界的支持與肯定，是公司繼續研究發展的原動力，讓我們一起為各位提供安全性與自動化的相關工程服務。

坤溢企業股份有限公司

總經理 譚中雄暨全體員工 上

INTRODUCTION

The production of GLOBE STAR "W" type safe power rails is the results of a technological breakthrough.

Being specialized in hoist repair and related engineering innovation, we provide our customers with excellent services backed up by persistent devotion, responsibility and advanced technology. In order to overcome the difficulties that we have been confronted with during part importing, we are dedicating ourselves to the production and innovation of parts and components. Also, we have obtained numerous patents approved either by the ROC or overseas countries. We supply our customers with readily available engineering materials and technical assistance to shorten your preparation time.

Power Rails

Knowing the Germany has been using safe power rails since 1912 and bare conductor simply doesn't guarantee safety, we began to research, develop, and then mass produce 60-200 amp continuous rails, and have been highly recommended by our business partners.

We discovered that there are no high amperage power rails available on market, so we began to produce "W" type power rails with reference to German-made units.

With support and affirmation from our customers, we will continue our research and development work, offering our clients safe and automated engineering services.

Quality is a basic requirement for **Globe Star** products.

壹、W型電軌特點

Features:

- Made of aluminum and edged with stainless steel, the surface of this unit is erosion-resistant, and will not become oxidized. Can be used in a damp environment, ensuring good connection and durability.
- With a "Λ" type contact surface, the brush can automatically correct its way as it moves forward on the rail. This type of surface maintains close contact, ensuring better electrical conduction. The lead angle of the conductor prevents the collector mount from tripping-out, enabling it to move more smoothly.

W320A·W600A·W850A 電軌特點

* 導體部分：

材質為鋁本體鑲不銹鋼；接觸面為不銹鋼，其作用為質密耐磨及表面不易氧化，可適應劣質溼氣較重之環境，而無銹蝕，接觸不良，或電刷磨損過快之毛病。

接觸面為“Λ”字型，電刷行走其溝底具有自動校正功能，增加接觸面積，並使接觸更緊密，導電效果更佳。導體端頭導角使集電架行走時更順暢，不會跳脫。

* 接頭部分：

加設一“U”型導入座，可使電軌導體延伸導入不會偏移，銜接密切，永無8字型插入式接觸不良及壓降過高之毛病。本電軌為參考西德之產品而設計製造，其設計理念佳，謹列上特點，歡迎比較。

* 電軌夾：

為塑鋼一體成型，按裝採直接壓迫嵌入法，方便簡單，免重覆鎖螺絲、節省時間。

* 集電架：

採用塑鋼製雙臂配強力型彈簧，結構設計完整、關節靈活、耐用。

* 電刷：

採日本及西德電刷原料，粉末冶金、精煉，並經繁瑣之加工程序而成，具有優良之導電性、耐磨性。

貳、工程實績照片 Performance



▲ 850A



▲ 850A



▲ 600A



▲ 320A



▲ 320A

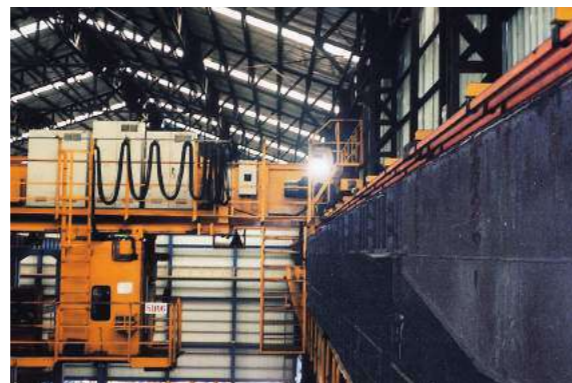

▲ 850A



▲ 320A / 600A



▲ 320A

※W型電軌工程實績用於中船、中鋼、台電、台機、台塑...等廠內設備。

參、選用何種安培數 General technical information

A. 交流三相電動機之全載電流表 Motor nominal currents

電動機形式 H · P	感應型及捲線型 Squirrelcage & wound rotor (Amp)					同步型 Synchronous Motor ※功率因數為整數 (Amp) On normal excitation			
	110V	220V	380V	440V	550V	220V	440V	380V	550V
1/2	4	2	1.2	1	0.8				
3/4	5.6	2.8	1.7	1.4	1.1				
1	7	3.5	2	1.8	1.4				
1 1/2	10	5	2.6	2.5	2				
2	13	6.5	3.5	3.3	2.6				
3	-	9	5	4.5	4				
5	-	15	8.5	7.5	6				
7 1/2	-	22	11.5	11	9				
10	-	27	15.5	14	11				
15	-	40	23	20	16				
20	-	52	30	26	21				
25	-	64	38	32	26	54	27	32	22
30	-	78	44	39	31	65	33	38	26
40	-	104	57	52	41	86	43	50	35
50	-	125	72	63	50	108	54	62	44
60	-	150	85	75	60	128	64	74	51
75	-	185	104	93	74	161	81	93	65
100	-	246	135	123	98	211	106	122	85
125	-	310	169	155	124	264	132	152	106
150	-	360	204	180	144	-	158	183	127
200	-	480	300	240	192	-	210	243	168

註：

- 額定電壓為208及200者，可讓220V之相當值各增加百分之6及10的負載。
- ※如功率因數為0.9及0.8者，左表有關數值應分別乘以1.1及1.25倍。
- 極數超過6極，及起動轉矩特別大者其全載電流大於本表之標準值，以據銘牌之標示值為準。
- 採錄自電工法規P.514。

B. 相關技術資料較繁多，請來電再行寄上，謝謝。

C. 負載曲線 Current-carrying diagram for different duty cycle

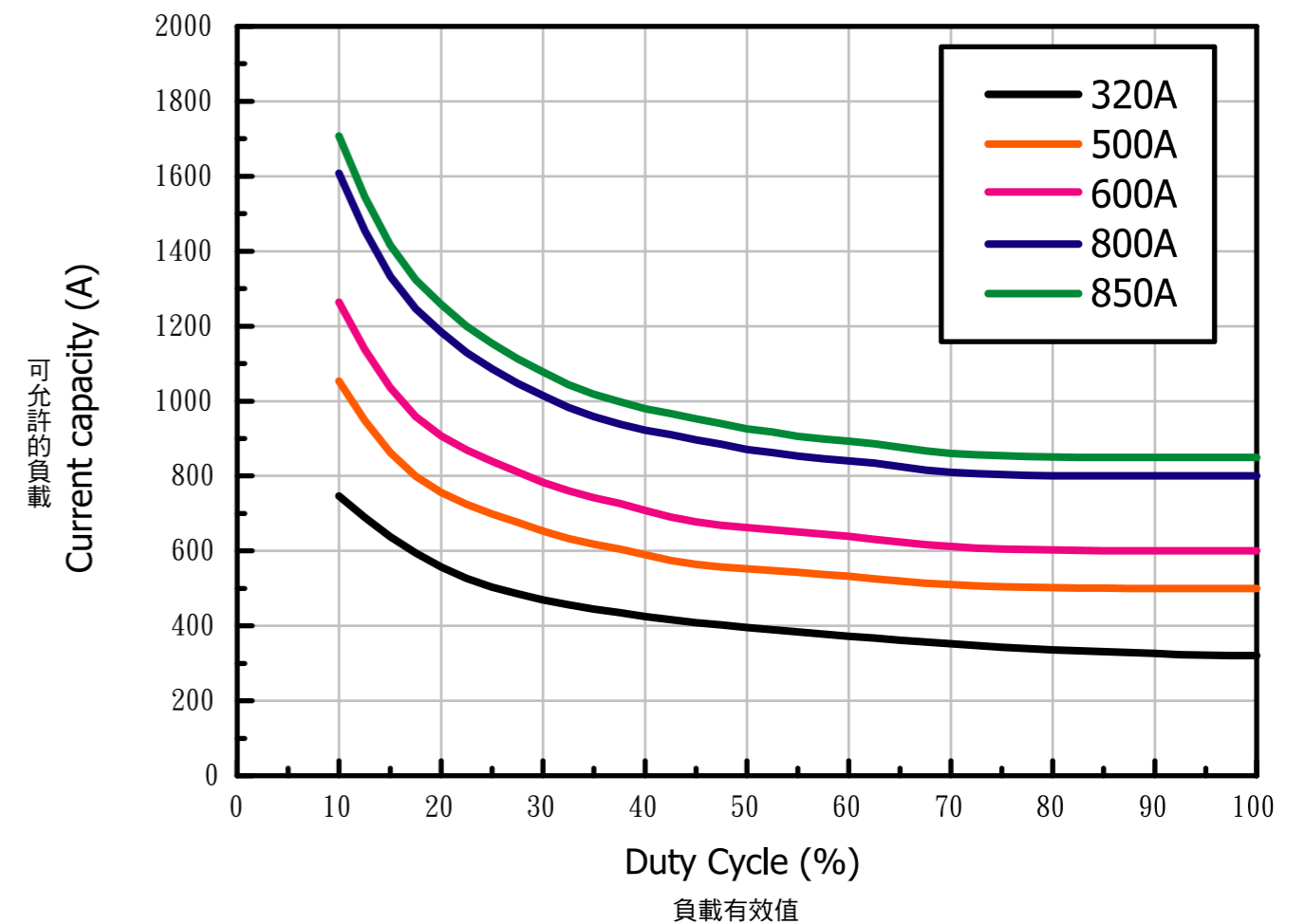

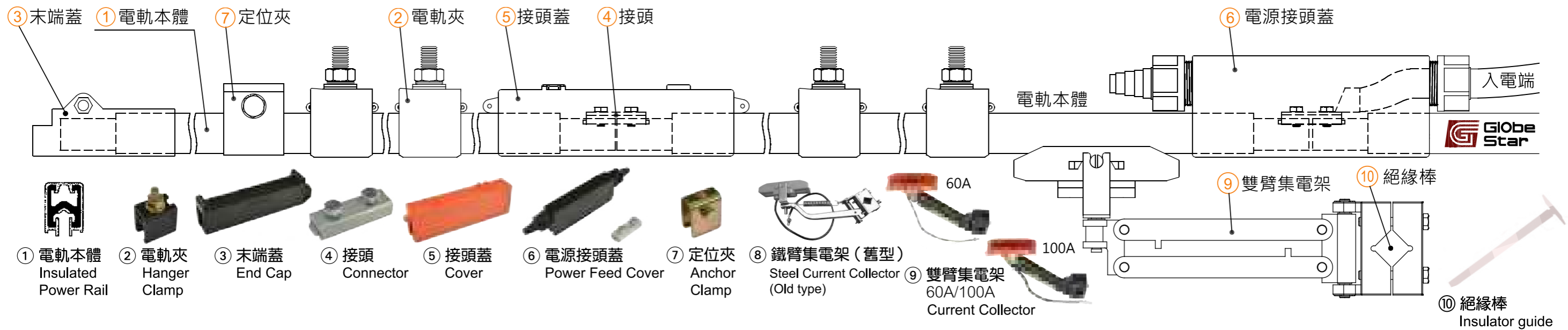

W型安全電軌供電系統

W型安全電軌供電系統

1 電軌 KY-AW2032 (鑲銅) 2.25kg/支
KY-AW2032S (鑲白鐵) 2.25kg/支

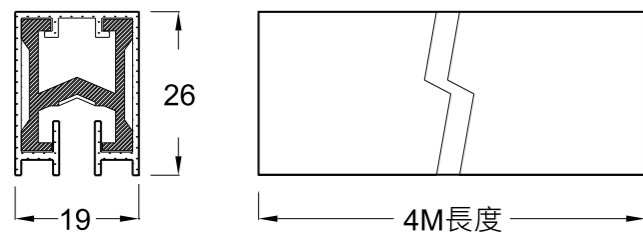

2 電軌夾 KY-AW2100 0.06kg/只

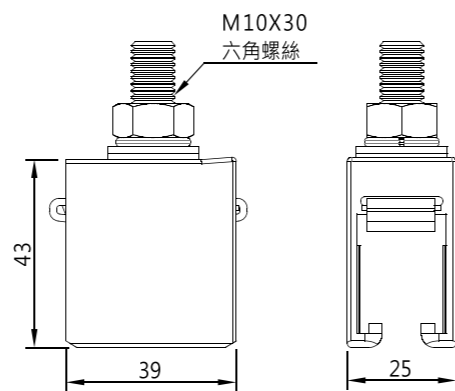

4 接頭 KY-AW2300 0.07 kg/只

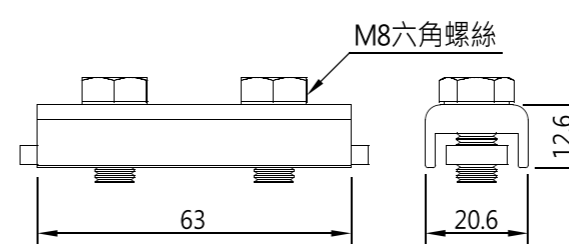

9 雙臂集電架 KY-AW2706 0.86kg/支
KY-AW2710 1.01kg/支

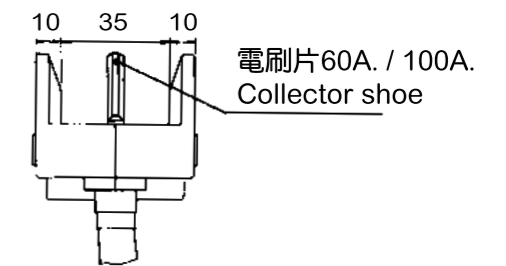

5 接頭蓋 KY-AW2400 0.06kg/只

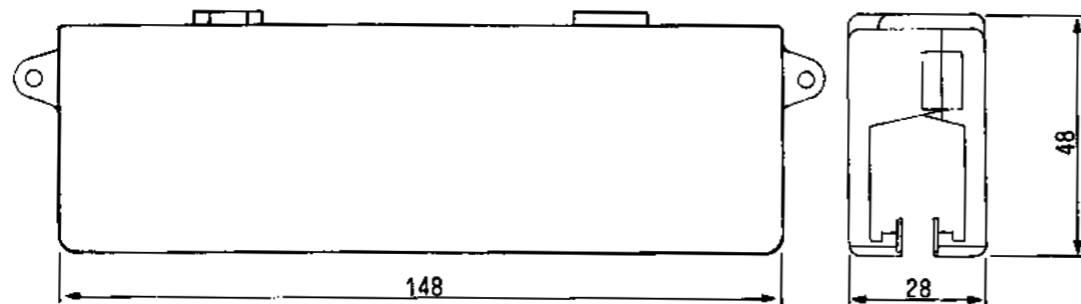

7 定位夾 KY-AW2600 0.08kg/只

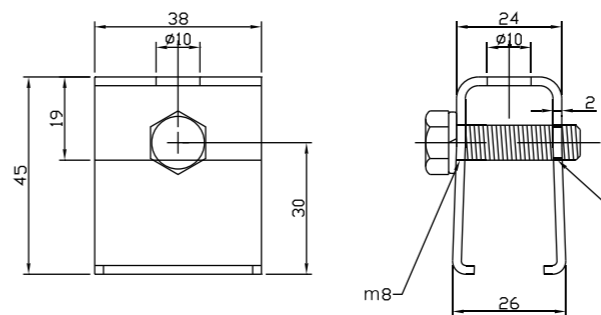

10 絕緣棒 KY-AN1838 1.45kg/支
KY-AN1850 1.83kg/支

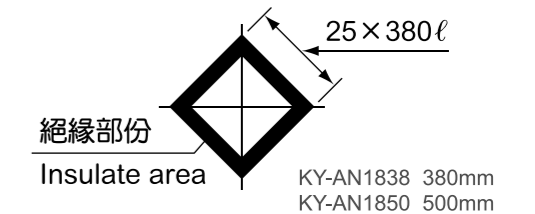

3 換軌末端蓋 KY-AW2700 0.04kg/只



3 末端蓋 KY-AW2200 0.02kg/只

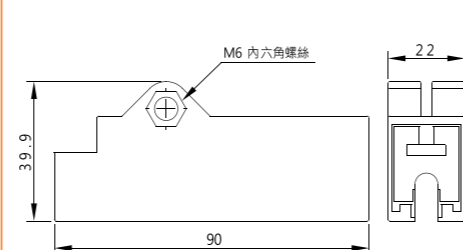

6 電源接頭蓋 KY-AW2500 0.17kg/只

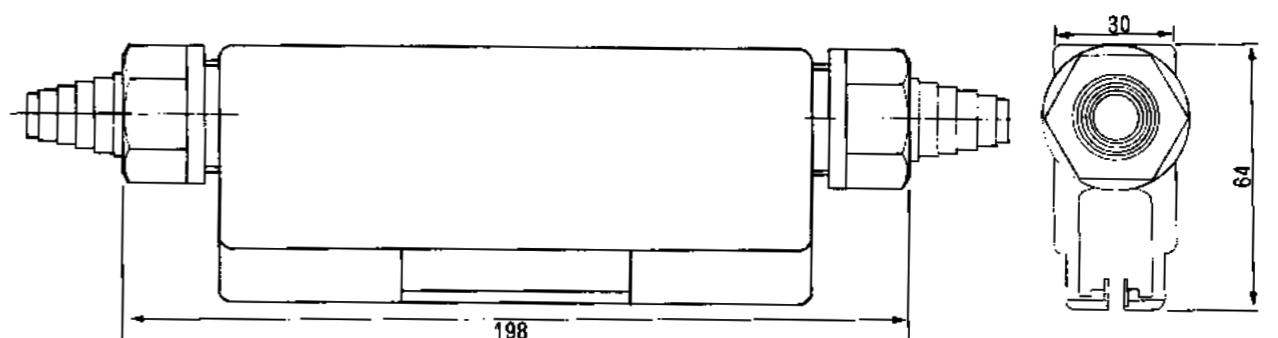

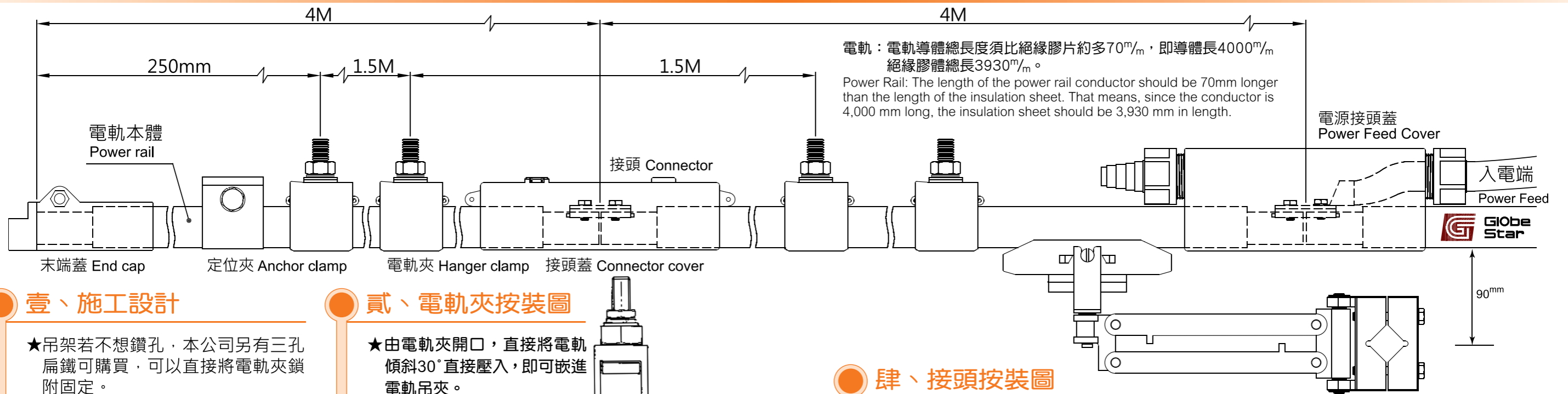

W型安全電軌供電系統

W型安全電軌供電系統

壹、施工設計

★吊架若不想鑽孔，本公司另有三孔扁鐵可購買，可以直接將電軌夾鎖附固定。

1. Construction Design

* If you don't want to drill holes for the hanger bar, please buy the bracket with three holes. The hanger clamp can be fixed on it directly.

A、立式施工圖 Vertical Design

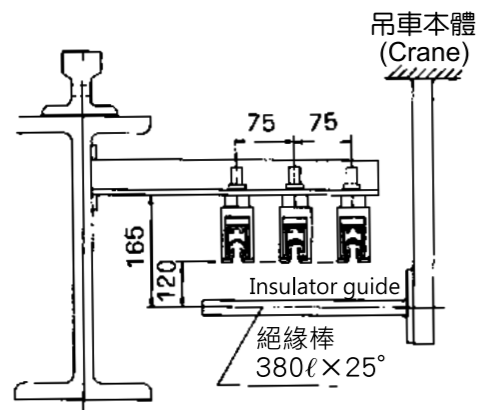

B、側式施工圖 Lateral Design

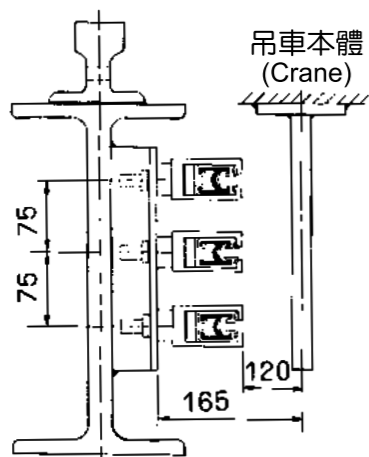

貳、電軌夾安裝圖

★由電軌夾開口，直接將電軌傾斜30°直接壓入，即可嵌進電軌吊夾。

2. Hanger Clamp Installation Diagram

* Insert the power rail into the opening of the hanger clamp in an obliqueness of 30 degrees, then the power rail can be hold by the clamp.

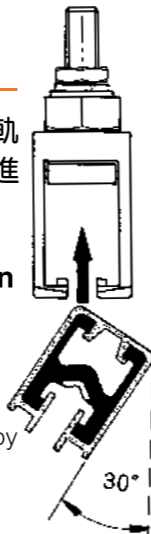

參、接頭蓋、電源蓋安裝圖

★電軌接頭蓋：先將蓋扣打開後，由下往上30°角以鉤角對凹槽，相向對中合在一起即可。

★電源蓋：方法與接頭蓋相同，先旋鬆塑膠螺母座，取下橡膠帽依電源線直徑，截出適合之孔徑穿線，鎖緊電源線，合蓋即可。

3. Connector Cover and Power Feed Cover Installation Diagram

* Connector cover: Open the cover, hook the scoop slot from bottom to top in 30 degrees and combine them together.

* Power feed cover: loosen the plastic nut, take the plastic cap off and cut it for a proper aperture for piercing through the transmission line, tighten it, then close the cover.

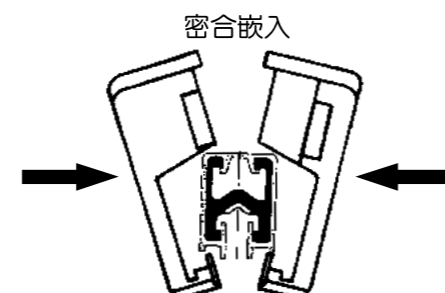

肆、接頭安裝圖

★先將接頭六角螺帽鬆開，順著U型導入座，插入電軌導體上方凹槽，兩端對中鎖緊即可。

4. Connector Installation Diagram

* Loosen the loose-resistant nut on the joint, plug it to the scoop slot on top of power rail conductor according to the "U" type guide base, then tighten the two units together.

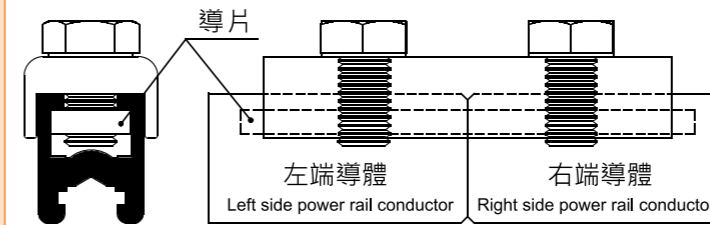

柒、絕緣棒、集電架安裝

★集電架與電軌平行，固定於絕緣棒。

7. Towing Arm and Current Collector Installation Diagram

* Put the collector parallelly with the power rail and fasten it on the insulating guide

伍、定位夾安裝圖

★每一條電軌線路，於電軌夾內外兩側以定位夾鎖緊防止電軌在電軌夾中間滑動。

在電軌夾未上前，先置入定位夾，待電軌夾鎖住後，再旋緊定位夾之六角螺絲即完成。

★安裝於最後那一端。

5. Anchor Clamp Installation Diagram

* The positioning clamp is for tightening from inside and outside the power rail clamp for each power rail circuit to protect the power rail from moving in between the power rail clamps.

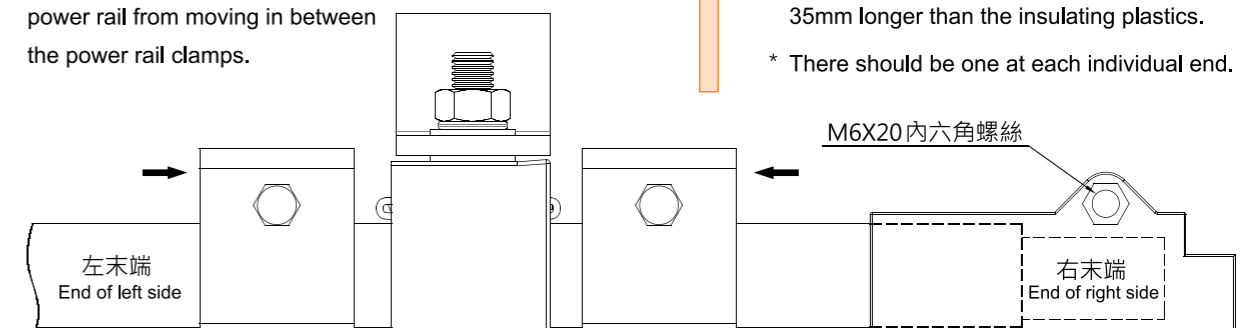

陸、末端蓋安裝圖

★將末端蓋插入電軌導體末端，敲二下即可。電軌導體末端須比絕緣塑膠多35mm。

★左右末端各一

6. End Cap Installation Diagram

* Insert the end cap to the end of the power rail conductor. knock twice will be OK. The end of the power rail conductor should be 35mm longer than the insulating plastics.

* There should be one at each individual end.

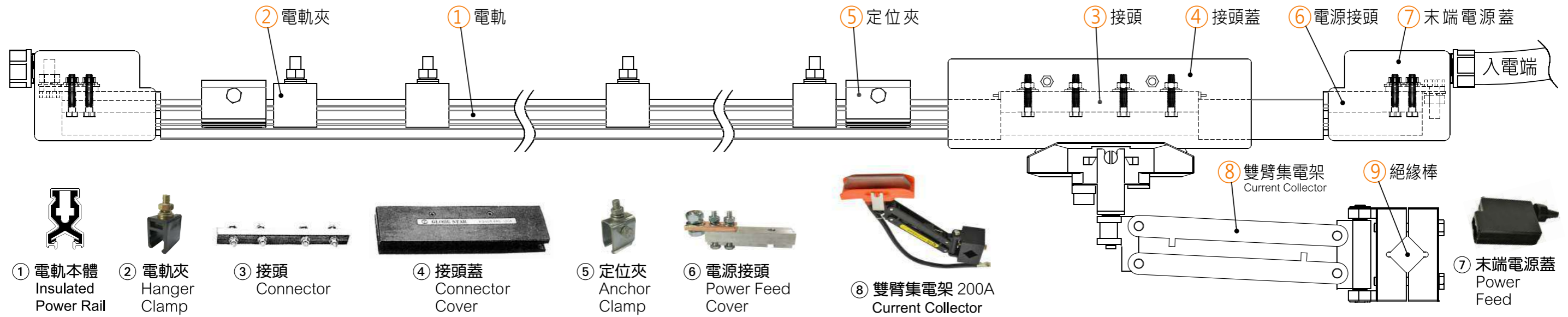

- 
① 電軌本體
Insulated Power Rail
- 
② 電軌夾
Hanger Clamp
- 
③ 接頭
Connector
- 
④ 接頭蓋
Connector Cover
- 
⑤ 定位夾
Anchor Clamp
- 
⑥ 電源接頭
Power Feed Cover
- 
⑧ 雙臂集電架 200A
Current Collector
- 
⑨ 絕緣棒
- 
⑦ 末端電源蓋
Power Feed

W型安全電軌供電系統

W型安全電軌供電系統

① 電軌 KY-AW5050E (鍍白鐵) 3.52kg/支

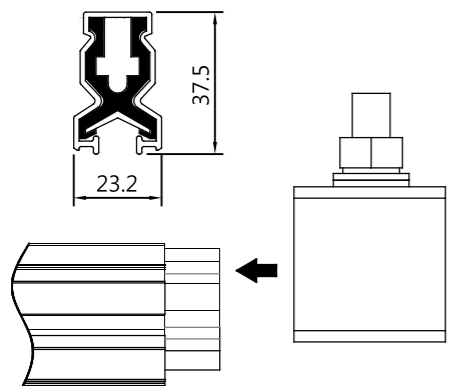

② 電軌夾 KY-AW5100 0.065kg/只

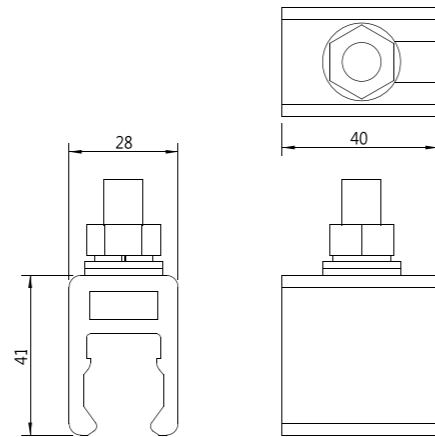

⑤ 定位夾 KY-AW5600 0.075kg/只

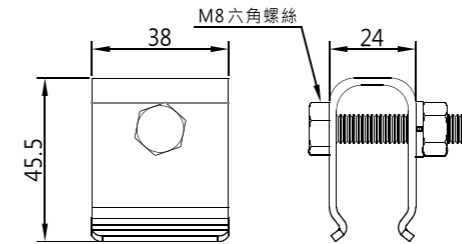

⑥ 末端電源接頭 KY-AW5301 0.16kg/只

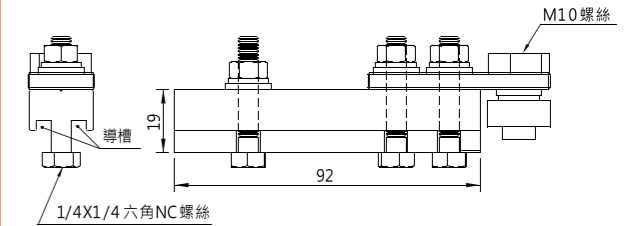

⑦ 末端電源蓋 KY-AW5500 0.9kg/組

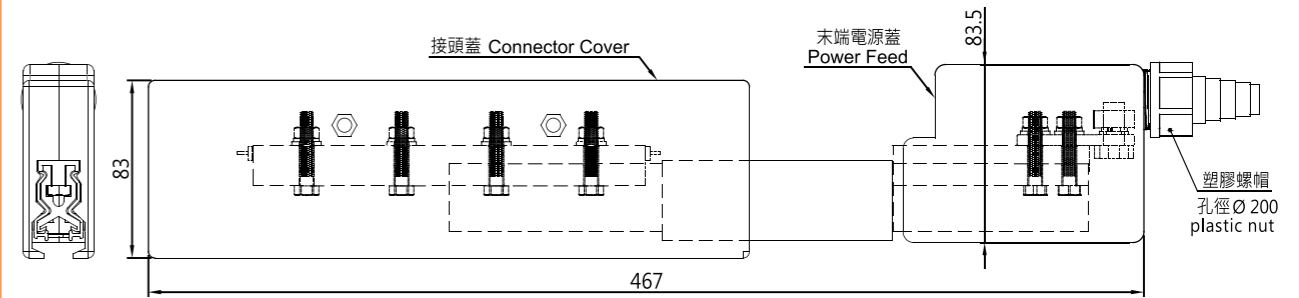

③ 接頭 KY-AW5300 0.17kg/只

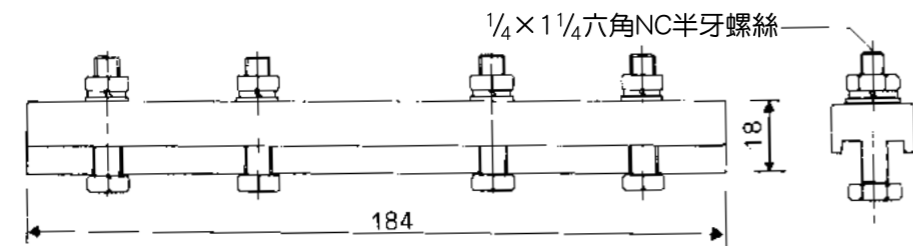

④ 接頭蓋 KY-AW5400 0.19kg/只

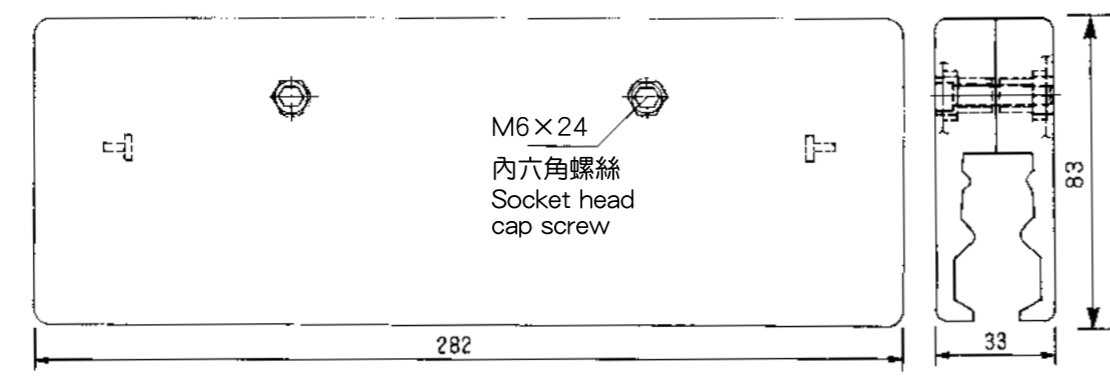

⑧ 雙臂集電架200A KY-AW2720 1.205kg/支

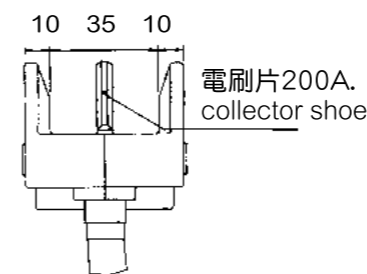

⑨ 絕緣棒 KY-AN1838 1.45kg/支
KY-AN1850 1.83kg/支

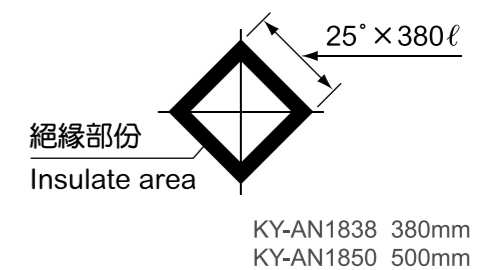

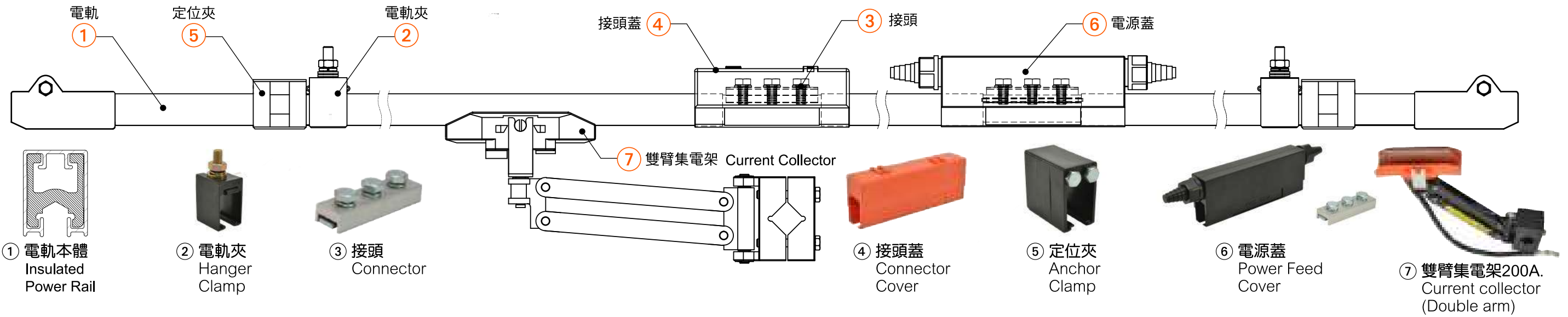

W型安全電軌供電系統

W型安全電軌供電系統

1 電軌 KY-AW6060 (鍍銅) 3.9kg/支

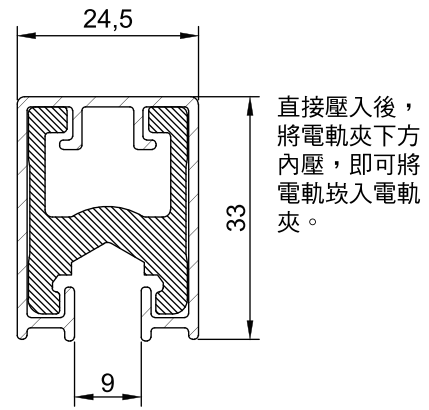

2 電軌夾 KY-AW6100 0.05kg/只

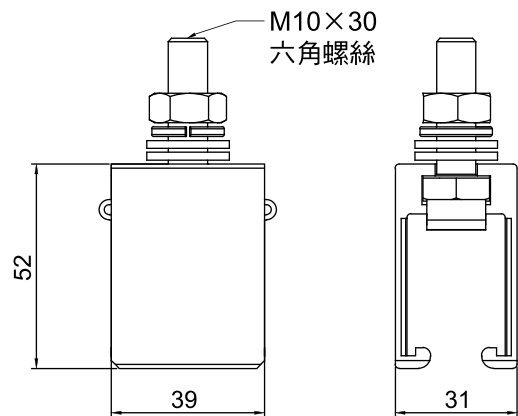

5 定位夾 KY-AW6600 0.05kg/只

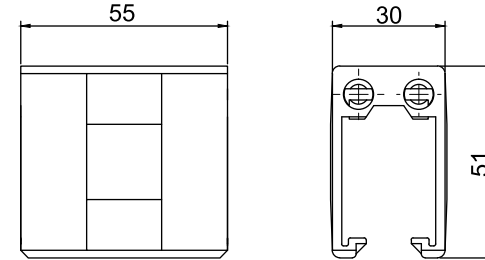

8 末端蓋 KY-AW6700 0.1kg/只

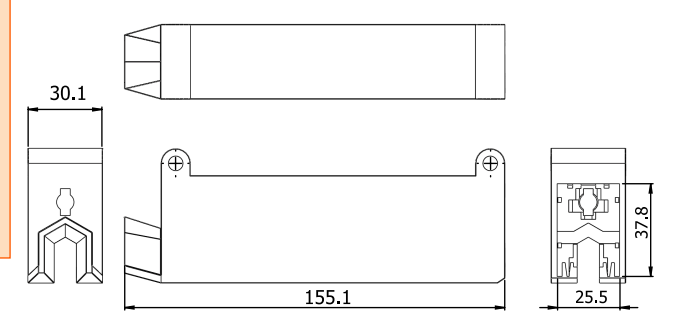

3 接頭 KY-AW6300 0.17 kg/只

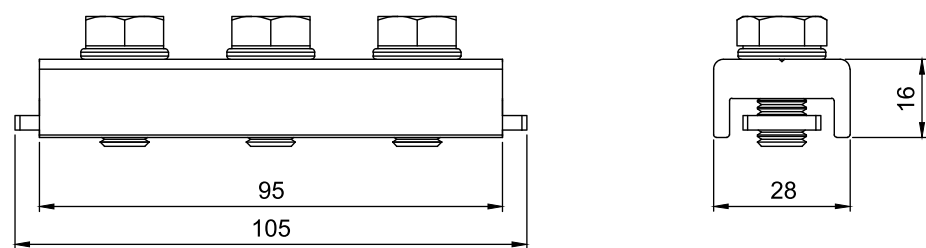

6 電源蓋 KY-AW6500 0.3kg/只

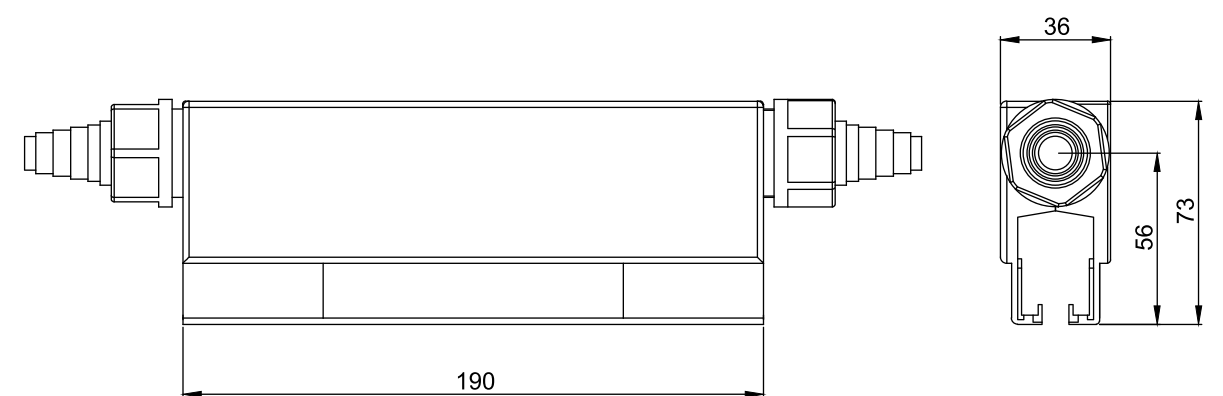

4 接頭蓋 KY-AW6400 0.17kg/只

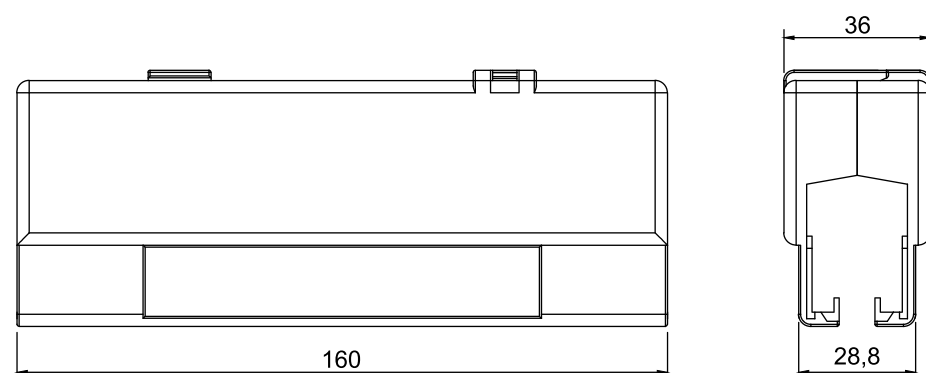

7 雙臂集電架200A KY-AW2720 1.21kg/支

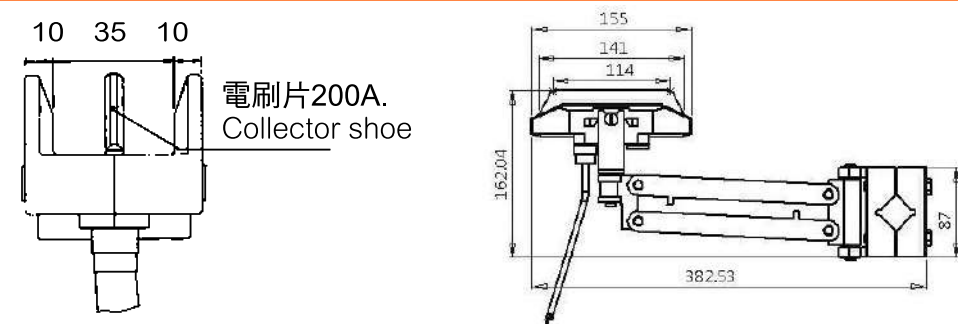

W型安全電軌供電系統

W型安全電軌供電系統

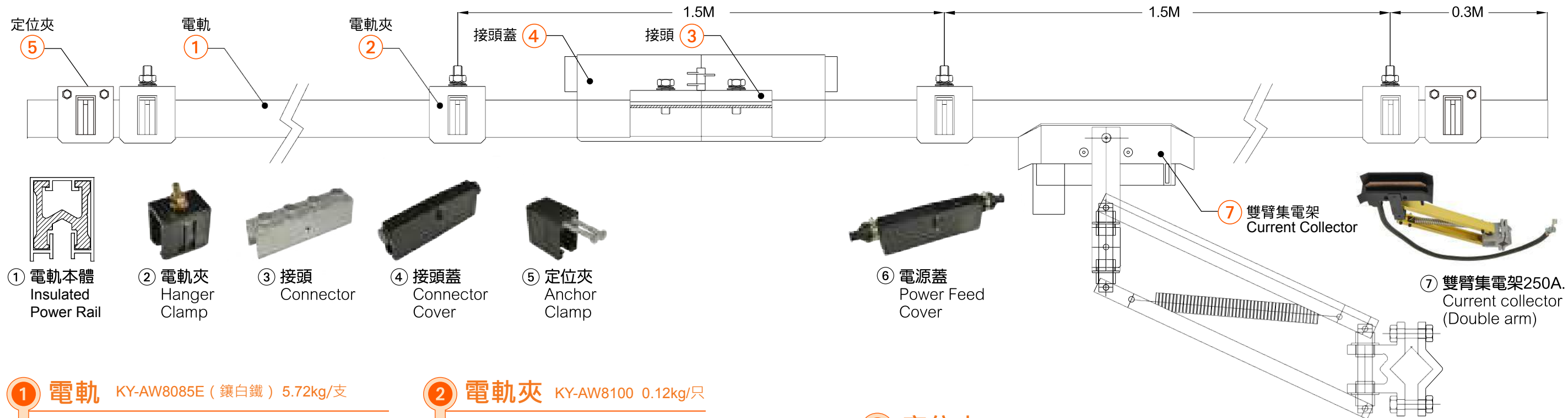

1 電軌 KY-AW8085E (鍍白鐵) 5.72kg/支

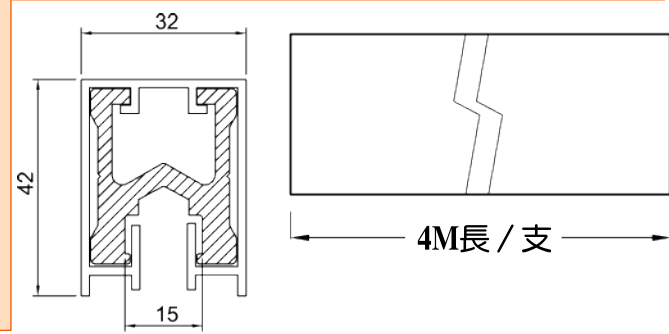

2 電軌夾 KY-AW8100 0.12kg/只

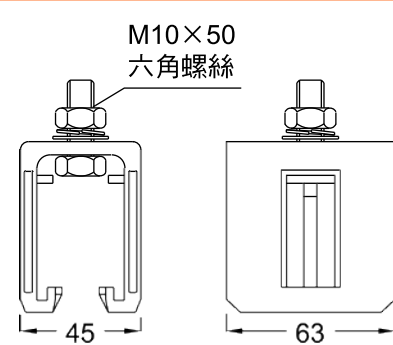

3 接頭 KY-AW8300 0.53kg/只

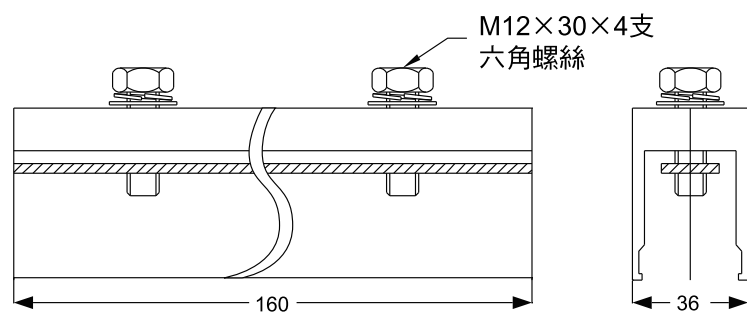

4 接頭蓋 KY-AW8400 0.36kg/只

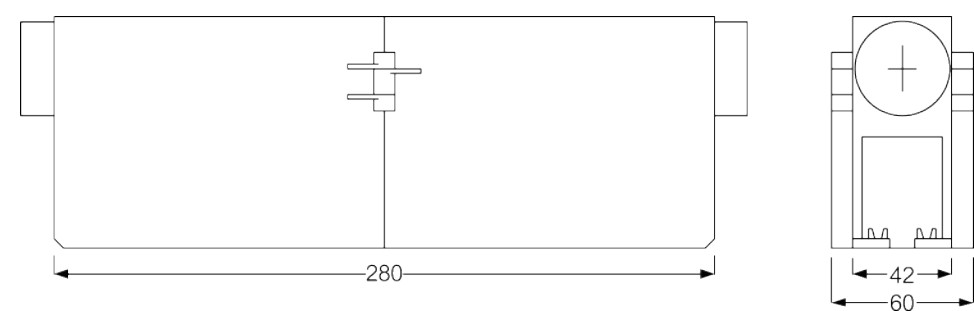

5 定位夾 KY-AW8600 0.11kg/只

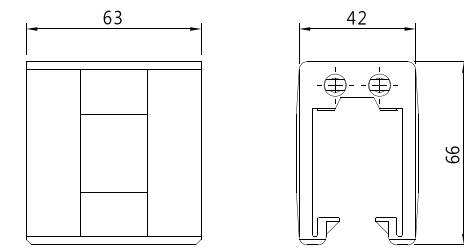

6 末端電源蓋

KY-AW8500
0.75kg/只

7 雙臂集電架250A KY-AW2725 3.29kg/支

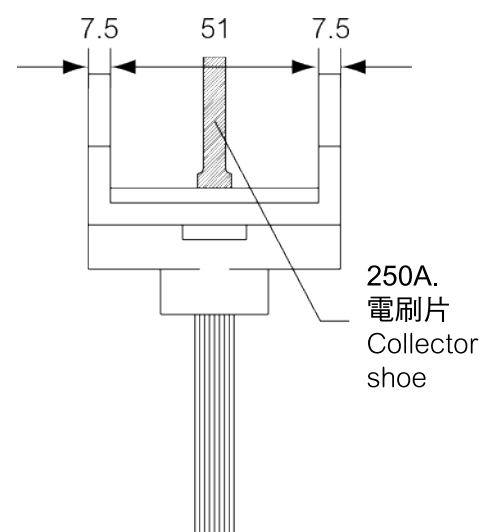

8 絕緣棒 KY-AN1838 1.45kg/支
KY-AN1850 1.83kg/支

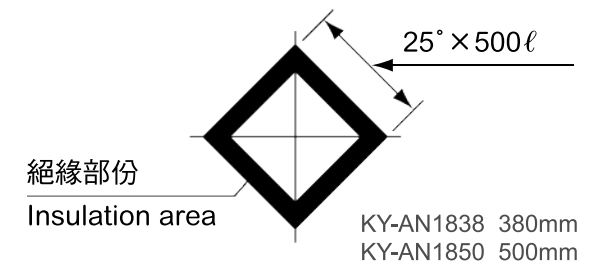

9 末端蓋 KY-AW8700 0.12kg/只

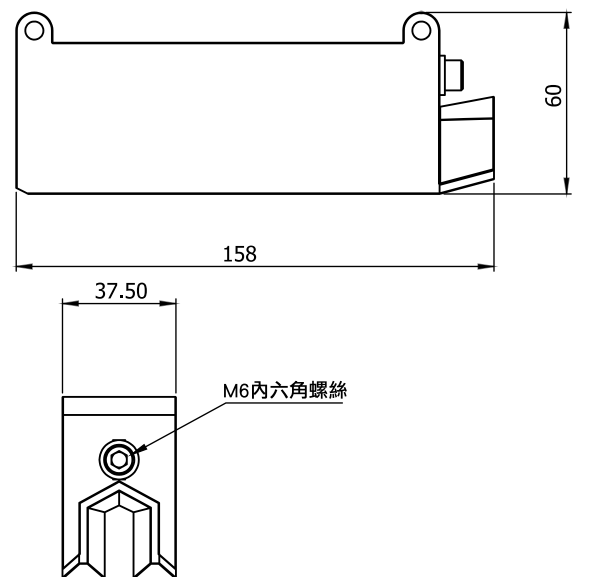

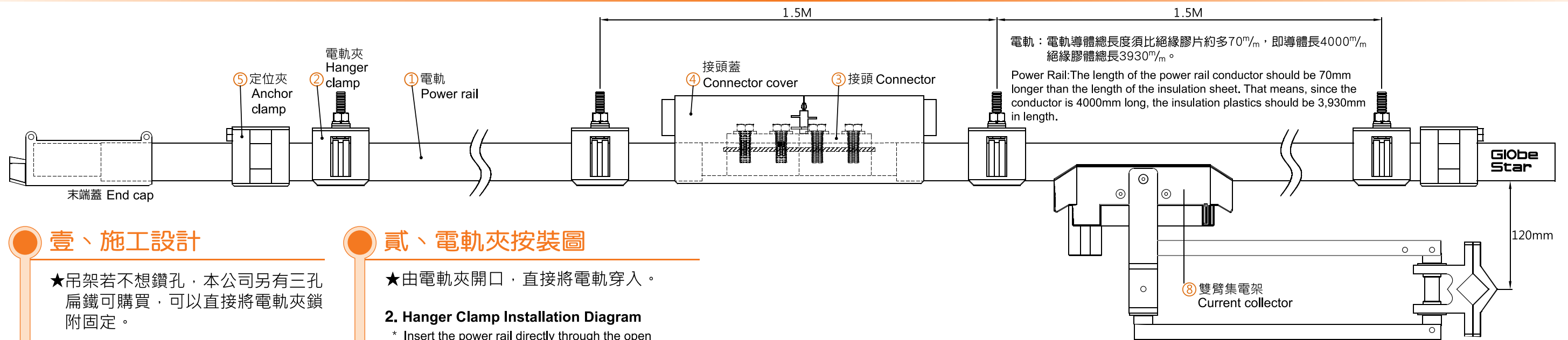

壹、施工設計

★吊架若不想鑽孔，本公司另有三孔扁鐵可購買，可以直接將電軌夾鎖附固定。

1. Construction Design

* If you don't want to drill holes for the hanger bar, please buy the bracket with three holes. The hanger clamp can be fixed on it directly.

A、立式施工圖 Vertical Design

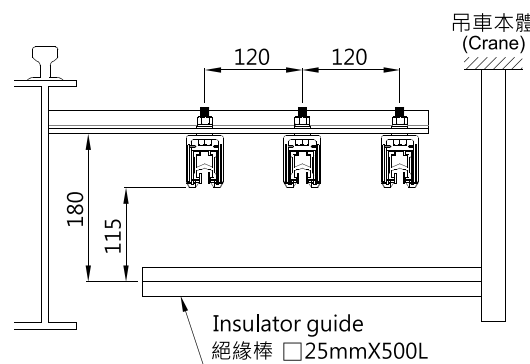

B、側式施工圖 Latera Design

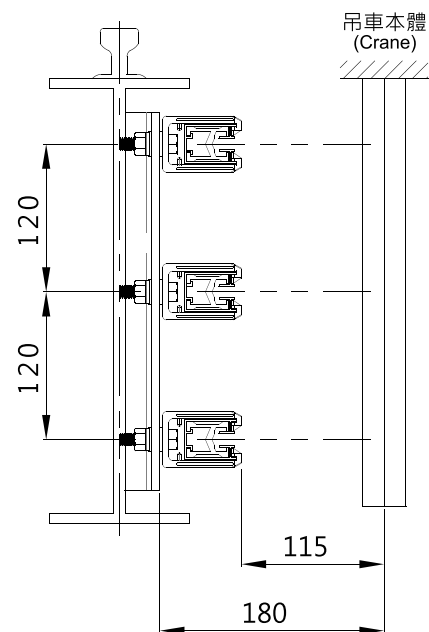

貳、電軌夾安裝圖

★由電軌夾開口，直接將電軌穿入。

2. Hanger Clamp Installation Diagram

* Insert the power rail directly through the open part of the hanger clamp.

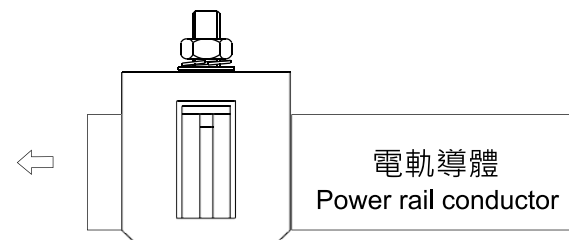

參、定位夾安裝圖

★每一條電軌線路，於電軌夾內外兩側以定位夾鎖緊防止電軌在電軌夾中間滑動。在電軌夾未上前，先置入定位夾，待電軌夾鎖住後，再旋緊定位夾之六角螺絲即完成。

★安裝於最後那一端。

3. Anchor Clamp Installation Diagram

* The positioning clamp is for tightening from inside and outside the power rail clamp for each power rail circuit to protect the power rail from moving in between the power rail clamps.

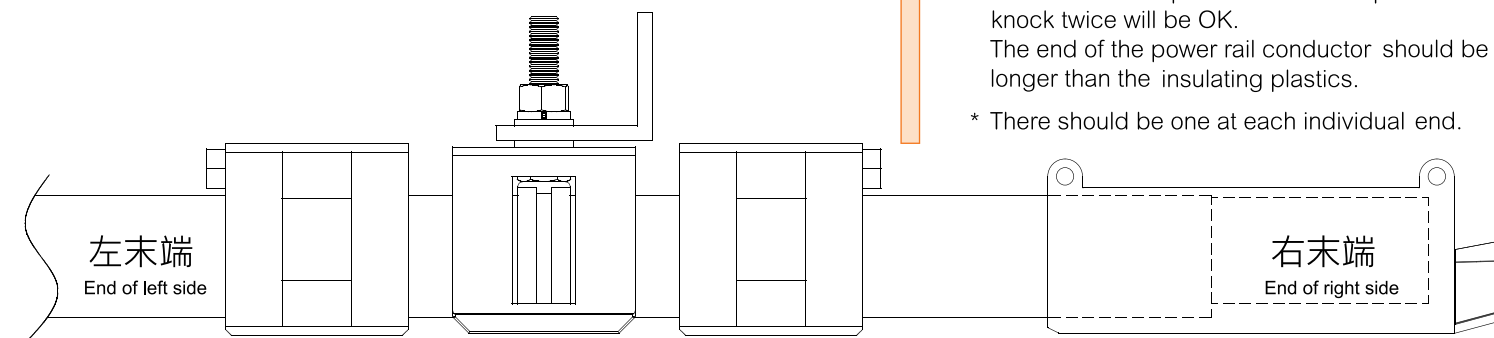

肆、接頭、接頭蓋安裝圖

★將接頭蓋左右兩端各穿入電軌左右導體，電軌導體各預留10公分。

★將兩端電軌導體順著接頭口型導入座，插入導體上方凹槽，將兩端導體對準中間鎖緊，即可鎖上螺絲固定。

★再將兩端接頭蓋往內側合併，併將插梢穿過固定孔後往外凹折固定。

4. Connector Installation Diagram

* Insert the left and right covers of the connector into the left and right power rail separately.
* Loosen the loose-resistant nut on the joint, plug it to the scoop slot on top of power rail conductor according to the "□" type guide base, then tighten the four nuts.
* Connect the left and right covers. Fix them by folding the fixing pins.

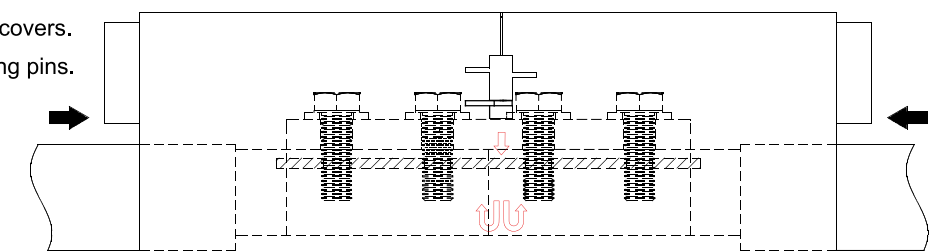

伍、末端蓋安裝圖

★將末端蓋插入電軌導體末端，敲二下即可。電軌導體末端須比絕緣塑膠多35mm。

★左右末端各一。

5. End Cap Installation Diagram

* Insert the end cap to the end of the power rail conductor. knock twice will be OK. The end of the power rail conductor should be 35mm longer than the insulating plastics.
* There should be one at each individual end.

陸、絕緣棒、集電架安裝

★集電架與電軌平行，固定於絕緣棒。

6. Towing Arm and Current Collector Installation Diagram

* Put the collector parallelly with the power rail and fasten it on the insulator guide.